

**DESCRIPTION**

The UCAN Drive Screw Anchor is manufactured from a tough and durable Nylon-6 and is preassembled with a zinc plated phillips head screw nail. The reinforced screw head holds the fixture firmly in place. This anchor is suitable for all masonry and concrete base materials.

**FEATURES**

- Ready to use, assembled fasteners for through fastening
- Impact expansion by hammer
- Removable with a screwdriver
- Environmentally friendly - contains no Cadmium
- Reinforced screw shoulder firmly grips the nylon body neck

**TYPICAL APPLICATIONS**

- Conduit clips
- Electrical boxes
- Brick ties
- Flashing
- Tilt-up forms
- Wood sleepers
- Drywall "hat" track

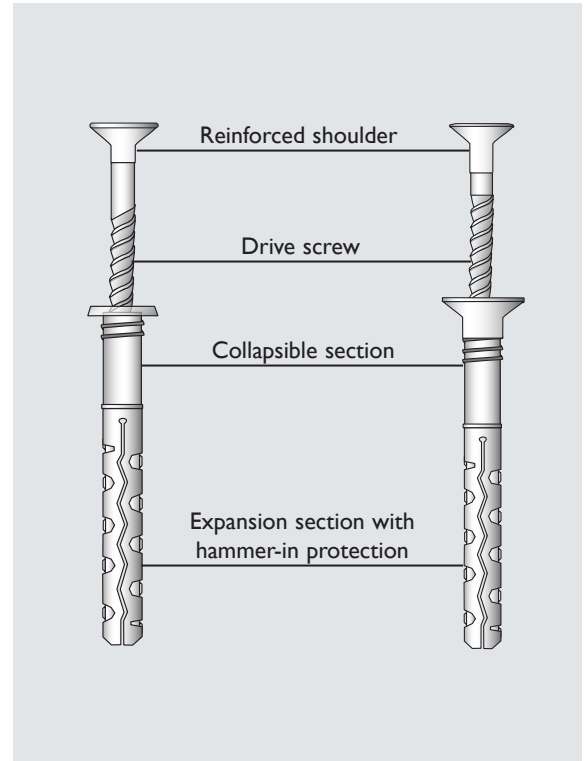

**ANCHOR SELECTION**

Head Style	Part Number	Anchor Length	Fastens up to	Drill Bit Diameter
		inch	inch	mm
Round Head	MNA530	1-1/4	1/4	5
	MNA540	1-1/2	1/2	5
	MNA550	2	1	5
	MNA635	1-3/8	3/8	6
	MNA650	2	1	6
	MNA670	2-3/4	1-3/4	6
Countersunk Head	MNA850	2	1	8
	MNA860	2-3/8	1	8
	MNA880	3-3/16	1-3/4	8
	MNA8100*	4	2-3/8	8

\*This size is not assembled

**INSTALLATION**

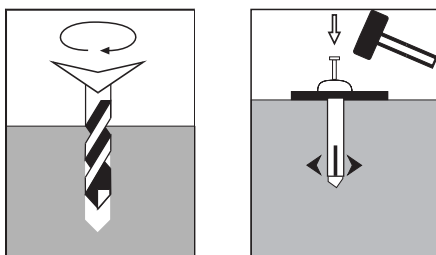

**MATERIAL SPECIFICATIONS**

**Anchor body**

- Cadmium free nylon
- In-place temperature: -40°C to +80°C
- Installation temperature: -10°C to +40°C

**Drive screw**

- Steel, zinc plated

**TECHNICAL DATA**

**Average Ultimate Loads**

Size	Minimum Embedment	3000 psi Concrete		Hollow Concrete Block*
		Tension	Shear	Tension
		lbs	lbs	lbs
mm	mm	(kN)	(kN)	(kN)
5	25	330 (1.50)	516 (2.3)	225 (1.00)
6	25	560 (2.50)	762 (3.4)	450 (2.00)
8	25	720 (3.20)	1255 (5.6)	670 (3.00)

\*Actual results may vary depending on concrete strength and installation conditions.

**NOTE:**

Apply Safety Factor to ensure the working load per anchor does not exceed 1/5 of the tabulated ultimate load, under static loading conditions.

**SPECIFICATION**

The following sample specification clause is arranged for inclusion in any one of a variety of master specification sections utilizing the Construction Specifications Canada (CSC) format. Brackets [...] indicate alternatives, data required, or need for the specifier to fill in information.

**ANCHORS (FASTENERS)**

Masonry anchors shall be [diameter, length to suit load and fixture requirements] UCAN Drive Screw Anchors, supplied by UCAN Fastening Products. Anchor shell to be nylon with no cadmium content, and installed according to the manufacturer's published instructions.